

## PRINTABLE INFO SHEET

Series: Blazer Select

Model: TD1001-P



## About This Model

Style: Ranch / Bedrooms: 3 / Bathrooms: 2 / Square Feet: 1387

## CUSTOMER CONTACT

Notes:

---

---

---

---

## PRINTABLE INFO SHEET

Series: Blazer Select

Model: TD1001-P



## Floorplan

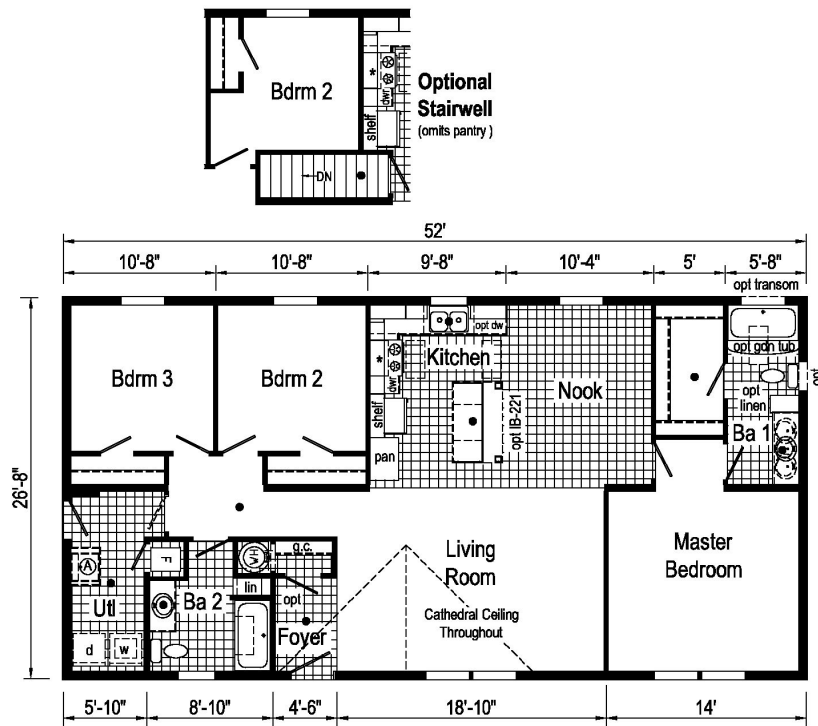

TD1001-P 2852 Approx. 1387 Sq. Ft.

\* = Std 4" staggered overhead cabinets with opt. flat ceiling  
 • = Std. can light  
 (A) = Std frz spc, opt utl sink or bench.

**Blazer Select**

Builder: Commodore Homes of Pennsylvania	Callout: 2852	Revisions: 3/4/21	Scale: #####	Date: 1/15/21	Custom: -	Model/Eng. No.: TD1001-P
Title: Literature	Date: 6/23/20	No. 3/1/21	Drawn By: OY	Reference: NONE	Dt: -	LIT
					S/N: -	Pg.:

## CUSTOMER CONTACT

Notes:

---



---



---



---

## PRINTABLE INFO SHEET

**Series: Blazer Select**

**Model: TD1001-P**



## Standards & Features

### Interior

Flat Ceiling Throughout  
Stipple Ceiling  
8' Sidewall Height  
Shaw Take Away Carpet  
Rebond Carpet Pad  
Tackstrip Carpet Installation  
Shaw Vinyl Flooring  
Vinyl Wall Coverings on Gypsum  
Pre-Hung White 2-Panel Interior  
Doors with 2 Mortised Hinges  
30" Interior Passage Doors  
Metal Interior Passage Sets  
Floor Mount Door Stops  
Smoke Detectors with Battery  
Back-Up  
Wire Shelving in Closets  
Designer-Coordinated Window  
Treatments  
LED Lights Throughout (except Bedrooms)

### Kitchen

KCMA Certified Cabinets  
Mission Cabinet Doors  
Concealed Cabinet Hinges  
Brushed Nickel Cabinet Hardware  
30" Staggered Overhead Cabinets  
Lined Base & Overhead Cabinets  
Soft Close Undermount Drawer Guides  
Base Shelves in Cabinets  
Laminate Countertops  
4" Laminate Backsplash

### Kitchen (continued)

Stainless Steel Sink - 33x22x8  
Hi-Rise Empire Brushed Nickel  
Kitchen Faucet

### Appliances

18 Cubic Foot, Black No-Frost Refrigerator  
30" Black Deluxe Electric Range  
Power Range Hood with Light

### Baths

60" Tub/Shower - 2 Piece  
1.6 Gallon Per Flush Elongated Toilets  
Laminate Countertops  
4" Laminate Backsplash  
Lighted Vent Fan in Each Bath  
Mission Cabinet Doors  
Concealed Cabinet Hinges  
Brushed Nickel Cabinet Hardware  
Base Shelf in Vanities  
36" High Vanities  
Empire Brushed Nickel Faucets

### Bedrooms

Switched Receptacles  
Egress Window Each Bedroom  
Wire Shelving in Wardrobes  
Recessed 6" LED Light  
in All Walk-In Closets & Pantry

### Utilities

Plumbed & Wired for Washer  
with Quarter Turn Valve  
Vented and Wired for Dryer  
200 AMP Electrical Service

## CUSTOMER CONTACT

Notes:

---

---

---

---



## PRINTABLE INFO SHEET

**Series: Blazer Select**

**Model: TD1001-P**



## Standards & Features (continued)

### Utilities (continued)

Copper Wiring Throughout  
30 Gallon Electric Water Heater  
with Pan  
Electric Furnace w/ Grilled Door  
Air Exchange System for Furnace  
Aluminum Heat Ducts  
In-Floor Cross-Over Heating System  
Air Conditioner Ready Thermostat  
w/ 5-Wires  
Main Water Line Shut-Off Valve

### Exterior

Gatsby at Front Door  
Seeded Glass Light at Rear Door  
GFI-Protected Exterior Receptacle  
Vinyl Dutch Lap Siding  
Sheathing Board Under Siding  
Shingle Roof with  
4" Eaves on Single Section Homes  
10" Eaves on Ranch Homes  
Ridgevent Roof Ventilation System  
6-Panel Fiberglass Front Door 38x80  
6-Panel Rear Door 34x80  
12" Raised Panel Shutters on  
Front Door Side

### Construction

Transverse Floor System  
2x6 - 14' & 28' Wide  
2x8 - 16' & 32' Wide  
2x6 Exterior Walls on 16" Centers\*\*  
20# Roof Load

### Construction (continued)

3/4" OSB T and G Floor Decking  
Recessed Frame

### Energy Efficient Standards

Vinyl Insulated Low-E Windows  
R-22 Fiberglass in Floor  
R-19 Fiberglass in Walls  
R-25 Avg. Blown in Ceiling-Single  
R-28 Avg. Blown in Ceiling-Multi

**\*\*NOTE: Spacing for Framing Members may vary due to Design**

Modular Features  
Primed / Finished Drywall Throughout  
OSB Sheathing  
Wind Wrap  
40# Roof Load  
5/12 Roof Pitch w/Ice Shield  
Architectural Shingles  
90 MPH Wind Zone Exp. C  
2x10 Floor Joist  
2x4 Interior Walls  
Additional Exterior Receptacle  
(1) Exterior Faucet  
Non Gridded Argon Windows Low-E  
R-31 Ceiling Insulation  
Water Shut Off Where Accessible  
200 AMP Panel Box  
Hardwood Cabinets w/Hardwood Stiles  
No Blinds or Curtains  
White Profile Moulding Package  
Structured Flow Brushed Nickel Metal Faucets  
Square China Lav Sinks

## CUSTOMER CONTACT

Notes:

---

---

---

---

## PRINTABLE INFO SHEET

**Series: Blazer Select**

**Model: TD1001-P**



## Standards & Features (continued)

**\*\*NOTE: Spacing for Framing Members may vary due to Design Requirements (continued)**

Perimeter Heat

Fiberglass One Piece Tub/Shower Combo

## CUSTOMER CONTACT

Notes:

---

---

---

---