

PRINTABLE INFO SHEET

Series: Blazer Elite

Model: TD1303-P Blazer Elite

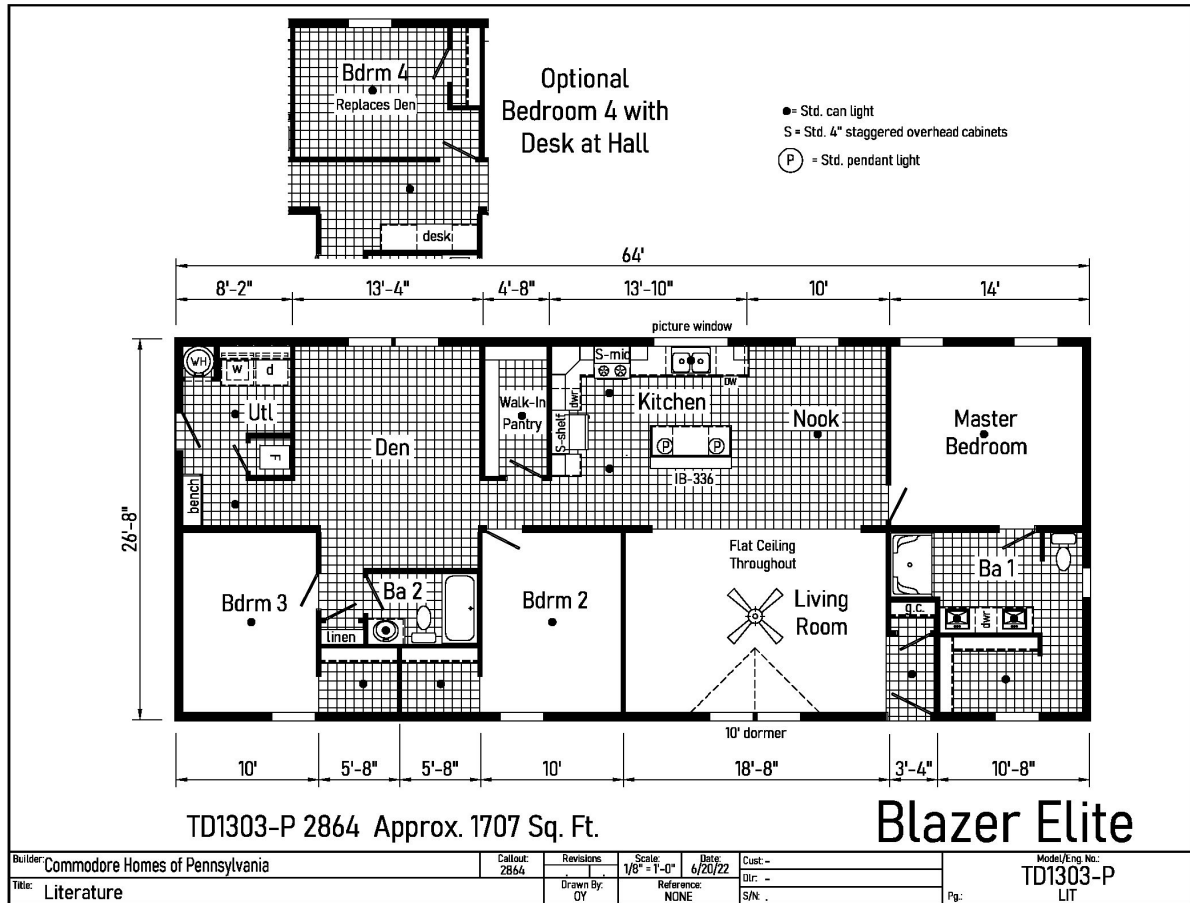

About This Model

Style: Ranch / Bedrooms: 3 / Bathrooms: 2 / Square Feet: 1707

CUSTOMER CONTACT

Notes:

PRINTABLE INFO SHEET

Series: Blazer Elite

Model: TD1303-P Blazer Elite



Standards & Features

Interior

Flat Ceiling Throughout
Stipple Ceiling
8' Sidewall Height
Take Away Carpet
Rebond Carpet Pad
Tackstrip Carpet Installation
Shaw Vinyl Flooring
Vinyl Flooring Entry Foyer
Vinyl Wall Coverings on Gypsum
Pre-Hung White 2-Panel Interior
Doors with 2 Mortised Hinges
30" Interior Passage Doors
Metal Interior Passage Sets
Floor Mount Door Stops
Smoke Detectors with Battery
Back-Up
Wire Shelving in Closets & Above W/D
Designer-Coordinated Window
Treatments
LED Lights Throughout
Ceiling Fan in Living Room

Kitchen

KCMA Certified Cabinets
Mission Cabinet Doors
Concealed Cabinet Hinges
Brushed Nickel Cabinet Hardware
30" Staggered Overhead Cabinets
Lined Base & Overhead Cabinets
Kitchen Island
Soft Close Undermount Drawer Guides

Kitchen (continued)

Base Shelves in Cabinets
Laminate Countertops
4" Laminate Backsplash
Stainless Steel Sink - 33x22x8
Hi-Rise Structured Flow Brushed Nickel
Kitchen Faucet
(2) Pendant Lights over Island

Appliances

20 CuFt, Stainless Steel Refrigerator w/Top
Freezer
30" Stainless Steel Deluxe Electric Range
Stainless Steel Dishwasher 4 Cycle
Stainless Steel Over the Range Microwave

Baths

60" Fiberglass Shower - Master Bath
60" One Piece Fiberglass Tub/Shower - Bath 2
1.6 Gallon Per Flush Elongated Toilets
Laminate Countertops
4" Laminate Backsplash
Lighted Vent Fan in Each Bath
Mission Cabinet Doors
Concealed Cabinet Hinges
Brushed Nickel Cabinet Hardware
Base Shelf in Vanities
36" High Vanities
Square China Lavs
Double Lav Sinks - Master Bath
Structured Flow Brushed Nickel Faucets

Bedrooms

LED Lights

CUSTOMER CONTACT

Notes:

PRINTABLE INFO SHEET

Series: Blazer Elite

Model: TD1303-P Blazer Elite



Standards & Features (continued)

Bedrooms (continued)

Egress Window Each Bedroom
Wire Shelving in Wardrobes
Recessed 6" LED Light
in All Walk-In Closets & Pantry

Utilities

Plumbed & Wired for Washer
with Quarter Turn Valve
Vented and Wired for Dryer
200 AMP Electrical Service
Copper Wiring Throughout
30 Gallon Electric Water Heater
with Pan
Water Shut Off Throughout
Main Water Shut off in Utility
Electric Furnace w/ Grilled Door
Air Exchange System for Furnace
Aluminum Heat Ducts
In-Floor Cross-Over Heating System
Air Conditioner Ready Thermostat
w/ 5-Wires

Exterior

Gatsby Light at Front Door
Seeded Glass Light at Rear Door
GFI-Protected Exterior Receptacle
(1) Exterior Water Faucet
Vinyl Dutch Lap Siding
Sheathing Board Under Siding
Shingle Roof with
4" Eaves on Single Section Homes
10" Eaves on Ranch Homes

Exterior (continued)

Ridgevent Roof Ventilation System
6-Panel Fiberglass Front Door 38x80
1-Lite Rear Door 34x80
12" Raised Panel Shutters on
Front Door Side

Construction

Transverse Floor System
2x6 - 14' & 28' Wide
2x8 - 16' & 32' Wide
2x6 Exterior Walls on 16" Centers**
20# Roof Load
3/4" OSB T and G Floor Decking
Recessed Frame
2 Adjustable Outriggers

Energy Efficient Standards

Vinyl Insulated Low-E Windows
R-22 Fiberglass in Floor
R-19 Fiberglass in Walls
R-25 Avg. Blown in Ceiling-Single
R-28 Avg. Blown in Ceiling-Multi

CUSTOMER CONTACT

Notes:
