

PRINTABLE INFO SHEET

Series: Richland ELITE Ranch

Model: GF3003-P



About This Model

Style: Ranch / Bedrooms: 3 / Bathrooms: 2 / Square Feet: 1600

CUSTOMER CONTACT

Notes:

PRINTABLE INFO SHEET

Series: Richland ELITE Ranch
 Model: GF3003-P



Floorplan

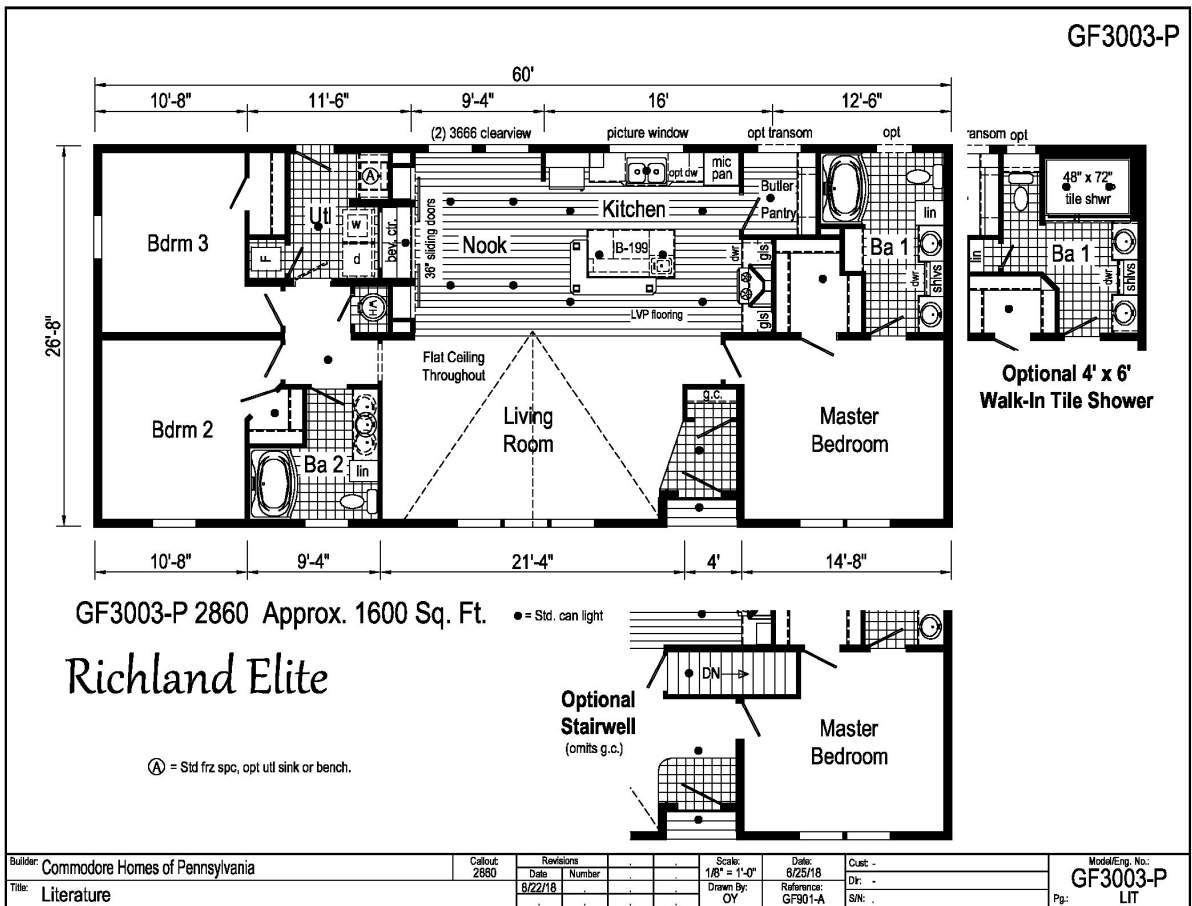

CUSTOMER CONTACT

Notes:

PRINTABLE INFO SHEET

Series: Richland ELITE Ranch
Model: GF3003-P



Standards & Features

Interior

8' Flat Stipple Ceilings
Profile Moulding Package
Ceiling Cove
Primed Finished Drywall Throughout
LED Lighting
Pre-Hung Door Jambs
Mortise Hinges
30" 6-Panel White Passage Doors
Metal Interior Passage Sets
Floor Mount Door Stops
Smoke Detectors with Battery Back-Up
Wire Shelving in Guest Closet
Designer-Coordinated Window Treatments
Picture Window over Kitchen Sink
2 Clearview Windows in Nook - per model

Exterior

Black Coach Light at Front and Rear Door
GFI-Protected Exterior Receptacle
Vinyl Dutch Lap Siding
OSB Sheathing Under Siding
Shingle Roof with 10" Eaves
Ridgevent Roof Ventilation System
38x82 6-Panel Fiberglass Front Door with Deadbolt Lock
6-Panel Fiberglass Rear Door
12" Raised Panel Shutters on Front Door Side

Construction

Transverse Floor System:
2x6 on 24 and 28 Wide Models

Construction (continued)

2x8 on 32 Wide Models
**2x6 Exterior Walls on 16" Centers
30# Roof Load
Recessed Frame Design

Kitchen

18 CF, Black Frost Free Refrigerator
30" Black Gas Range
Stainless 30" Range Hood
Stainless Steel Sink - 33x19x7
Structured Flow Hi-Rise Brushed Nickel Faucet
Beverage Center w/Barn Style Sliding Doors, Wine Rack, & Open Shelving
Butler Pantry w/Storage Shelves & Small Appliance Center (Most Models)
42" Overhead Cabinets
Soft Close Cabinet Doors
4" Ceramic Backsplash on Sink Wall
Full Ceramic Backsplash Range Area
LED Lighting

Baths

60" One Piece Fiberglass Garden Tub/Shower
Deluxe Shower Drape at 60" Tubs
1.6 Gallon Per Flush Elongated Toilets
Square China Lav Sinks
Lighted Vent Fan in Each Bath
Brushed Nickel Metal Faucets - Structured Flow
Vanity Light in Master Bath
4" Ceramic Backsplash in Baths

Cabinetry

Classic Craft Custom Cabinetry

CUSTOMER CONTACT

Notes:

PRINTABLE INFO SHEET

Series: Richland ELITE Ranch
Model: GF3003-P



Standards & Features (continued)

Cabinetry (continued)

(KCMA Certified)

- Hardwood Mission Cabinet Doors
- Hardwood Stiles
- Hardwood Cabinet Crown Moulding
- Hardwood Under Cabinet Moulding
- Drawer Over Door Base Cabinets
- Soft Close Cabinet Doors
- 5" Transitional Cabinet Pulls on Doors & Drawers
- Concealed Cabinet Hinges
- Adjustable Shelves in Overhead Cabinets
- Undermount Soft-Close Drawer Guides
- Adjustable Center Shelf in Base Cabinets
- Laminate Countertops with Crescent Edge
- Base Shelf in Vanities
- 36" High Vanities

Utilities

- Washer and Dryer Area
- Plumb and Wire for Washer Including Quarter Turn Valve
- Wire and Vent for Dryer
- 100 AMP Electrical Service
- Copper Wiring Throughout
- 40 Gallon Electric Water Heater with Pan
- Programmable Thermostat
- Gas Furnace
- Furnace Door - 6-Panel Door with Grill
- Air Exchanger System for Furnace
- Aluminum Heat Ducts
- Perimeter Heating System with In-Floor

Utilities (continued)

- Cross-Overs
- Main Water Line Shut-Off Valve
- One Exterior Faucet
- Water Shut-off Valves Where Accessible

Flooring

- Vinyl Plank Flooring per Plan
- 18 oz. Carpet Lucerne/Innovations
- Rebond Carpet Pad with Tackstrip
- Carpet Installation
- Congoleum LuxFlor Vinyl Floor Coverings

Bedrooms

- Ceiling Lights
- Egress Window Each Bedroom
- Wire Shelving in Wardrobes
- Switched Recessed 4" LED Light in All Walk-In Closets

Energy Efficient Standards

- Low-E Vinyl Insulated Windows
- R-22 Fiberglass Insulation in Floor
- R-19 Fiberglass Insulation in Walls
- R-31 Avg. Blown Insulation in Ceiling
- **NOTE: Spacing for Framing Members may vary due to Design Requirements

Modular Features:

- 2x10 Transverse Floor System
- 40# Roof Load
- 5/12 Roof Pitch with 10" Eaves
- Architectural Shingles
- 200 Amp Electrical Services
- (1) Phone Jack

CUSTOMER CONTACT

Notes:

PRINTABLE INFO SHEET

Series: Richland ELITE Ranch

Model: GF3003-P



Standards & Features (continued)

Modular Features: (continued)

No Floor Insulation

Hi-Efficiency Furnace

90 MPH Wind Zone Exp. C

Wind Wrap

2x4 Interior Walls

Additional Exterior Receptacle

Low-E Argon Windows

No Blinds or Curtains

White Moulding Package

Floorplan may be altered based on building code.

CUSTOMER CONTACT

Notes:
