

# PRINTABLE INFO SHEET

Series: Astro Creations Singlewide  
 Model: 1A2004-P

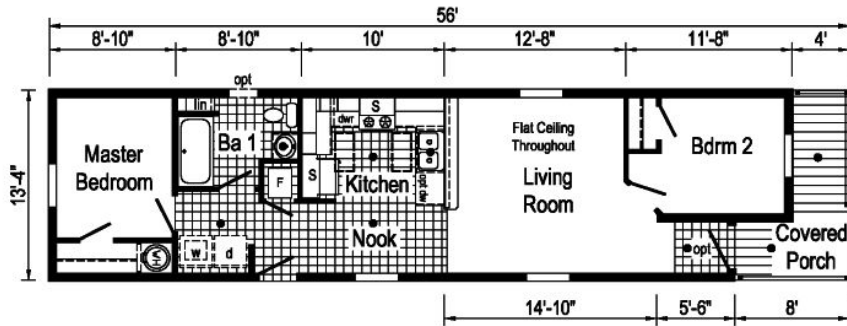

1A2004-P 1456 Approx. 677 Sq. Ft.

● = Std. can light  
 S = Std. 4" staggered overhead cabinets

Builder: Commodore Homes of Pennsylvania	Callout: 1456	Revisions:	Scale: 1/8" = 1'-0"	Date: 4/17/2020	Client: -	Model/Eng. No.: 1A2004-P
Title: Literature		Date: .	Drawn By: OY	Reference: TS114-A	DR: .	LIT
		No.:			SR: .	Pg: .

## About This Model

Style: Single / Bedrooms: 2 / Bathrooms: 1 / Square Feet: 677

## CUSTOMER CONTACT

Notes: \_\_\_\_\_

\_\_\_\_\_

\_\_\_\_\_

\_\_\_\_\_

# PRINTABLE INFO SHEET

Series: Astro Creations Singlewide

Model: 1A2004-P



## Standards & Features

### Interior

- Cathedral Ceiling Throughout
- Stipple Ceiling
- 7'6" Sidewall Height
- 16 oz. Treasure Carpet
- Rebond Carpet Pad
- Tackstrip Carpet Installation
- No-Wax LuxFlor Vinyl Floor
- Vinyl Wall Coverings on Gypsum
- LED Flush Mount Lighting
- Pre-Hung White 6-Panel Interior Doors with 2 Mortised Hinges
- 30" Interior Passage Doors
- Metal Interior Passage Sets
- Floor Mount Door Stops
- Smoke Detectors with Battery Back-Up
- Wire Shelving in Closets
- Designer-Coordinated Window Treatments

### Kitchen

- KCMA Approved Cabinetry
- Mission Cabinet Doors
- Concealed Cabinet Hinges
- Brushed Nickel Cabinet Hardware
- 30" Staggered Overhead Cabinets
- Cabinet Crown Moulding
- Lined Base & Overhead Cabinets
- Soft Close Undermount Drawer Guides
- Base and Center Shelves in Cabinets
- Laminate Countertops

### Kitchen (continued)

- Stainless Steel Sink - 33x19x7
- Hi-Rise Empire Brushed Nickel Kitchen Faucet

### Appliances

- 30" Deluxe Gas Range
- Power Range Hood with Light
- 18 Cubic Foot, No-Frost Refrigerator

### Baths

- 60" Tub/Shower - 2 Piece
- 1.6 Gallon Per Flush Toilets
- China Stool, Tank and Lid
- Laminate Countertops
- Lighted Vent Fan in Each Bath
- Mission Cabinet Doors
- Concealed Cabinet Hinges
- Brushed Nickel Cabinet Hardware
- Base Shelf in Vanities
- 36" High Vanities
- Empire Brushed Nickel Faucets

### Bedrooms

- Switched Receptacles
- Egress Window Each Bedroom
- Wire Shelving in Wardrobes
- Recessed 4" LED Light in All Walk-In Closets & Pantry

### Utilities

- Plumbed & Wired for Washer with Quarter Turn Valve
- Vented and Wired for Dryer
- 100 AMP Electrical Service

## CUSTOMER CONTACT

Notes:

---

---

---

---

## PRINTABLE INFO SHEET

Series: Astro Creations Singlewide

Model: 1A2004-P



## Standards & Features (continued)

### Utilities (continued)

Copper Wiring Throughout  
30 Gallon Electric Water Heater with Pan  
Gas Furnace w/ Grilled Door  
Air Exchange System for Furnace  
Aluminum Heat Ducts  
In-Floor Cross-Over Heating System on Sectionals  
Air Conditioner Thermostat w/ 5-Wires  
Main Water Line Shut-Off Valve

### Exterior

Brushed Nickel Lantern at Front Door  
White Glass Jar Light at Rear Door  
GFI-Protected Exterior Receptacle  
Vinyl Dutch Lap Siding  
Sheathing Board Under Siding  
Shingle Roof with  
" Eaves on Single Section Homes  
10" Eaves on Ranch Homes  
Ridgevent Roof Ventilation System  
6-Panel Fiberglass Front Door 38x80  
6-Panel Fiberglass Rear Door 34x80  
12" Raised Panel Shutters on  
Front Door Side

### Construction

Transverse Floor System  
2x6 - 14' & 28' Wide  
2x8 - 16' & 32' Wide  
2x6 Exterior Walls on 16" Centers\*\*  
20# Roof Load  
3/4" OSB T&G Floor Decking  
Recessed Frame Design

### Energy Efficient Standards

Vinyl Insulated Low-E Windows  
R-14 Fiberglass in Floor  
R-19 Fiberglass in Walls  
R-25 Avg Blown in Ceiling-Single

## CUSTOMER CONTACT

Notes:

---

---

---

---