

# PRINTABLE INFO SHEET

Series: Astro Creations Ranch  
 Model: 3A2006-P

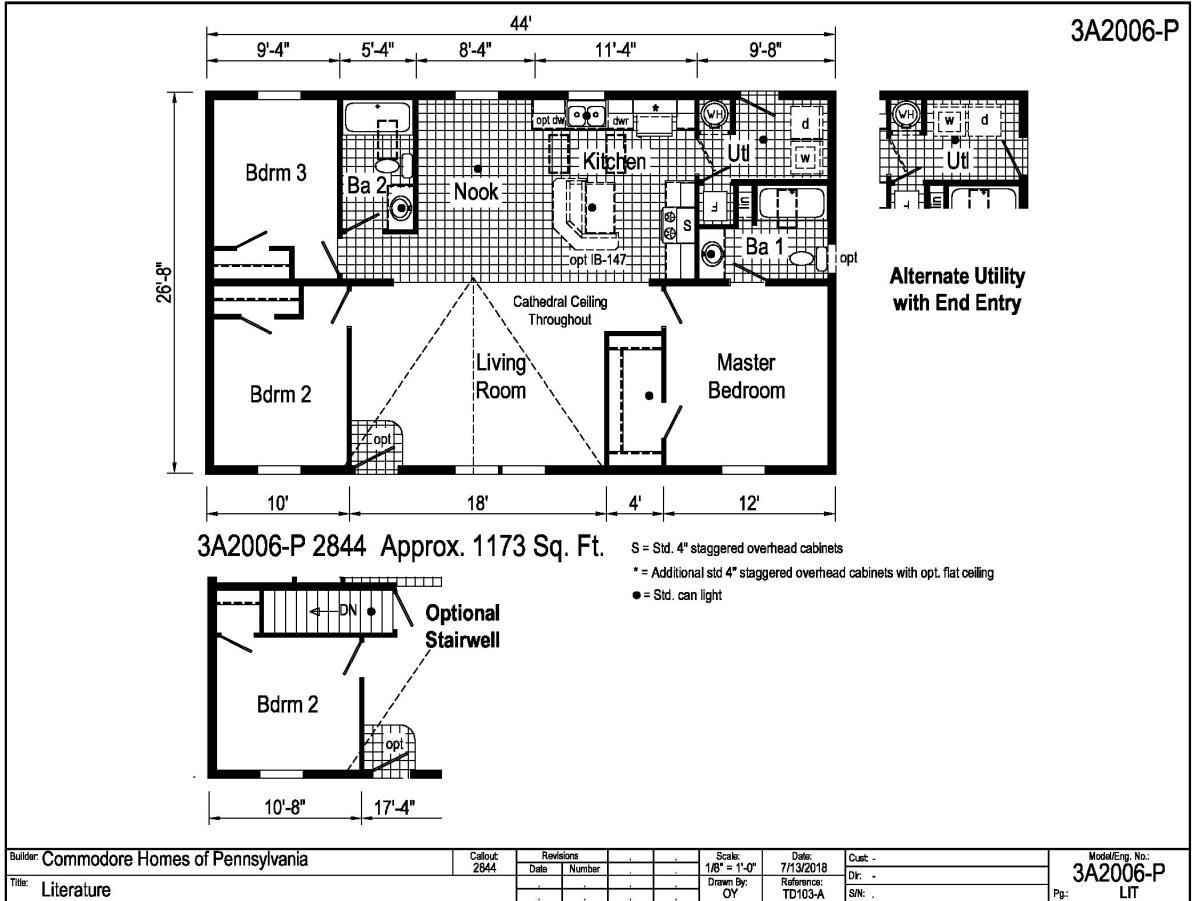

## About This Model

Style: Ranch / Bedrooms: 3 / Bathrooms: 2 / Square Feet: 1173

## CUSTOMER CONTACT

Notes: \_\_\_\_\_

\_\_\_\_\_

\_\_\_\_\_

\_\_\_\_\_

# PRINTABLE INFO SHEET

**Series: Astro Creations Ranch**  
**Model: 3A2006-P**



## Standards & Features

### Interior

Flat Ceiling Throughout - Single  
Cathedral Ceiling Throughout - Ranch  
Stipple Ceiling  
8' Sidewall Height - Single  
7'6" Sidewall Height - Ranch  
18 oz. Carpet Lucerne/Innovations  
Rebond Carpet Pad  
Tackstrip Carpet Installation  
No-Wax LuxFlor Vinyl Floor  
Vinyl Wall Coverings on Gypsum  
LED Flush Mount Lighting  
Pre-Hung White 6-Panel Interior  
Doors with 2 Mortised Hinges  
30" Interior Passage Doors  
Metal Interior Passage Sets  
Floor Mount Door Stops  
Smoke Detectors with Battery  
Back-Up  
Wire Shelving in Closets  
Designer-Coordinated Window  
Treatments

### Kitchen

KCMA Certified Cabinetry  
Mission Cabinet Doors  
Concealed Cabinet Hinges  
Brushed Nickel Cabinet Hardware  
30" Staggered Overhead Cabinets  
Cabinet Crown Moulding  
Lined Base & Overhead Cabinets  
Soft Close Undermount Drawer Guides

### Kitchen (continued)

Base and Center Shelves in Cabinets  
Laminate Countertops  
4" Laminate Backsplash  
Stainless Steel Sink - 33x19x7  
Hi-Rise Empire Brushed Nickel  
Kitchen Faucet

### Appliances

18 Cubic Foot, Black No-Frost Refrigerator  
30" Black Deluxe Gas Range  
Power Range Hood with Light

### Baths

60" Tub/Shower - 2 Piece  
1.6 Gallon Per Flush Elongated Toilets  
Laminate Countertops  
4" Laminate Backsplash  
Lighted Vent Fan in Each Bath  
Mission Cabinet Doors  
Concealed Cabinet Hinges  
Brushed Nickel Cabinet Hardware  
Base Shelf in Vanities  
36" High Vanities  
Empire Brushed Nickel Faucets

### Bedrooms

Switched Receptacles  
Egress Window Each Bedroom  
Wire Shelving in Wardrobes  
Recessed 4" LED Light  
in All Walk-In Closets & Pantry

### Utilities

Plumbed & Wired for Washer

## CUSTOMER CONTACT

Notes:

---

---

---

---

## PRINTABLE INFO SHEET

**Series: Astro Creations Ranch**  
**Model: 3A2006-P**



## Standards & Features (continued)

### Utilities (continued)

with Quarter Turn Valve  
Vented and Wired for Dryer  
100 AMP Electrical Service  
Copper Wiring Throughout  
30 Gallon Electric Water Heater with Pan  
Gas Furnace w/ Grilled Door  
Air Exchange System for Furnace  
Aluminum Heat Ducts  
In-Floor Cross-Over Heating System on Sectionals  
Air Conditioner Thermostat w/ 5-Wires  
Main Water Line Shut-Off Valve

### Exterior

Black Coach Light at Front Door  
Seeded Glass Light at Rear Door  
GFI-Protected Exterior Receptacle  
Vinyl Dutch Lap Siding  
Sheathing Board Under Siding  
Shingle Roof with  
4" Eaves on Single Section Homes  
10" Eaves on Ranch Homes  
Ridgevent Roof Ventilation System  
6-Panel Fiberglass Front Door 38x80  
6-Panel Fiberglass Rear Door 34x80  
12" Raised Panel Shutters on  
Front Door Side

### Construction

Transverse Floor System  
2x6 - 14' & 28' Wide  
2x8 - 16' & 32' Wide  
2x6 Exterior Walls on 16" Centers\*\*

### Construction (continued)

20# Roof Load  
3/4" OSB T&G Floor Decking  
Recessed Frame Design

### Energy Efficient Standards

Vinyl Insulated Low-E Windows  
R-14 Fiberglass in Floor  
R-19 Fiberglass in Walls  
R-25 Avg. Blown in Ceiling-Single  
R-28 Avg. Blown in Ceiling- Multi

**\*\*NOTE: Spacing for Framing Members may vary due to Design**

## CUSTOMER CONTACT

Notes:

---

---

---

---