

# PRINTABLE INFO SHEET

Series: Astro Bungalow

Model: 1A2601-P

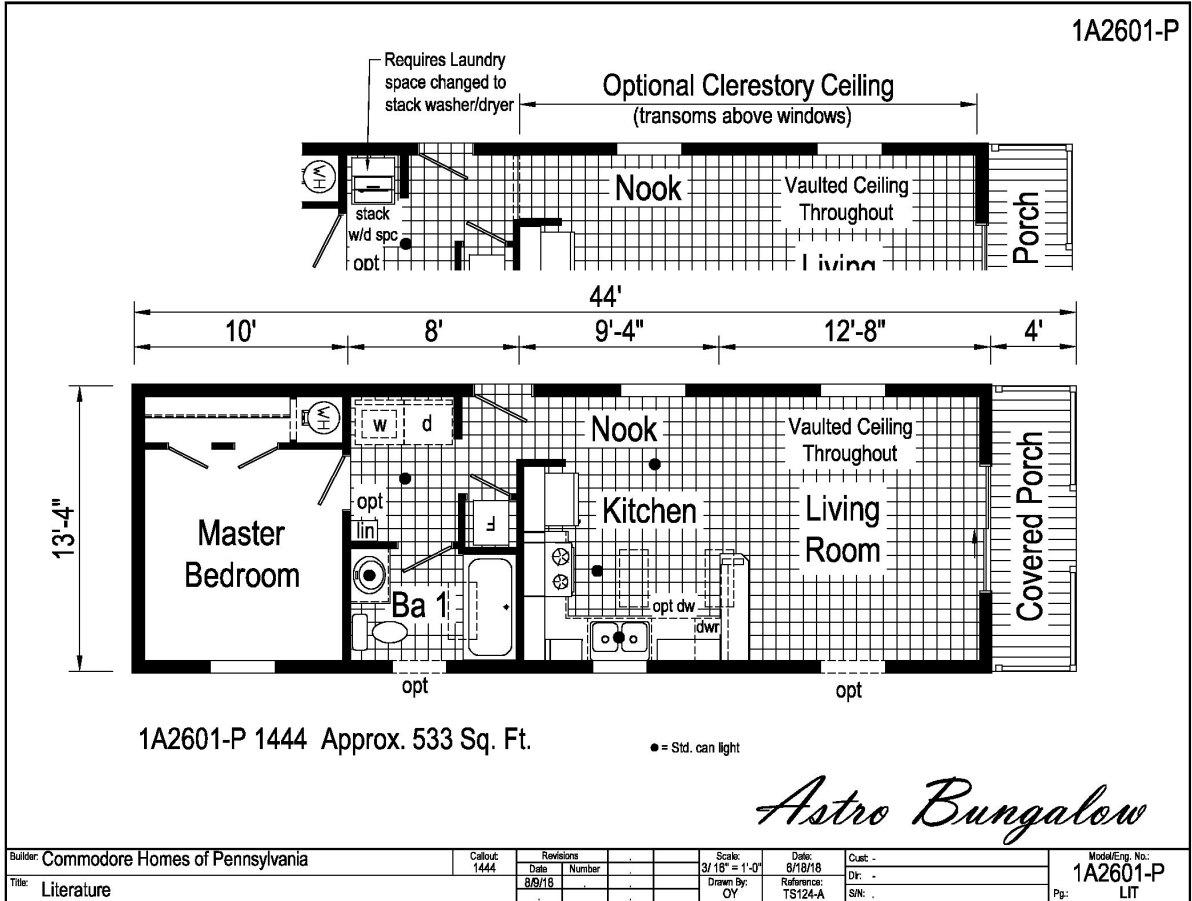

## About This Model

Style: Single / Bedrooms: 1 / Bathrooms: 1 / Square Feet: 533

## CUSTOMER CONTACT

Notes:

---



---



---



---

# PRINTABLE INFO SHEET

**Series: Astro Bungalow**

**Model: 1A2601-P**



## Standards & Features

### Interior

Cathedral Ceiling Throughout - Ranch  
Flat Ceiling Throughout - Single  
Stipple Ceiling  
8' Sidewall Height - Single  
7'6" Sidewall Height - Ranch  
18 oz. Carpet Lucerne/Innovations  
Rebond Carpet Pad  
Tackstrip Carpet Installation  
No-Wax LuxFlor Vinyl Floor  
Vinyl Wall Coverings on Gypsum  
LED Flush Mount Lighting  
Pre-Hung White 6-Panel Interior  
Doors with 2 Mortised Hinges  
30" Interior Passage Doors  
Metal Interior Passage Sets  
Floor Mount Door Stops  
Smoke Detectors with Battery  
Back-Up  
Wire Shelving in Closets  
Designer-Coordinated Window  
Treatments

### Kitchen

KCMA Certified Cabinetry  
Mission Cabinet Doors  
Concealed Cabinet Hinges  
Brushed Nickel Cabinet Hardware  
30" Staggered Overhead Cabinets  
Cabinet Crown Moulding  
Lined Base & Overhead Cabinets  
Soft Close Undermount Drawer Guides

### Kitchen (continued)

Base and Center Shelves in Cabinets  
Laminate Countertops  
4" Laminate Backsplash  
Stainless Steel Sink - 33x19x7  
Hi-Rise Empire Brushed Nickel  
Kitchen Faucet

### Appliances

18 Cubic Foot, Black No-Frost Refrigerator  
30" Black Deluxe Gas Range  
Power Range Hood with Light

### Baths

60" Tub/Shower - 2 Piece  
1.6 Gallon Per Flush Elongated Toilets  
Laminate Countertops  
4" Laminate Backsplash  
Lighted Vent Fan in Each Bath  
Mission Cabinet Doors  
Concealed Cabinet Hinges  
Brushed Nickel Cabinet Hardware  
Base Shelf in Vanities  
36" High Vanities  
Empire Brushed Nickel Faucets

### Bedrooms

Switched Receptacles  
Egress Window Each Bedroom  
Wire Shelving in Wardrobes  
Recessed 4" LED Light  
in All Walk-In Closets & Pantry

### Utilities

Plumbed & Wired for Washer

## CUSTOMER CONTACT

Notes:

---

---

---

---

# PRINTABLE INFO SHEET

**Series: Astro Bungalow**

**Model: 1A2601-P**



## Standards & Features (continued)

### Utilities (continued)

- with Quarter Turn Valve
- Vented and Wired for Dryer
- 100 AMP Electrical Service
- Copper Wiring Throughout
- 30 Gallon Electric Water Heater with Pan
- Gas Furnace w/ Grilled Door
- Air Exchange System for Furnace
- Aluminum Heat Ducts
- In-Floor Cross-Over Heating System
- Air Conditioner Thermostat w/ 5-Wires
- Main Water Line Shut-Off Valve

### Exterior

- Black Coach Light at Front Door
- Seeded Glass Jar Light at Rear Door
- GFI-Protected Exterior Receptacle
- Vinyl Dutch Lap Siding
- Sheathing Board Under Siding
- Shingle Roof with
- 4" Eaves on Single Section Homes
- 10" Eaves on Ranch Homes
- Ridgevent Roof Ventilation System
- 6-Panel Fiberglass Front Door 38x80
- 6-Panel Fiberglass Rear Door 34x80
- 12" Raised Panel Shutters on Front Door Side

### Construction

- Transverse Floor System
- 2x6 - 14' & 24' Wide
- 2x8 - 16' Wide
- 2x6 Exterior Walls on 16" Centers\*\*

### Construction (continued)

- 20# Roof Load
- 3/4" OSB T&G Floor Decking
- Recessed Frame Design

### Energy Efficient Standards

- Vinyl Insulated Low-E Windows
- R-14 Fiberglass in Floor
- R-19 Fiberglass in Walls
- R-25 Avg. Blown in Ceiling-Single
- R-28 Avg. Blown in Ceiling- Multi
- \*\*NOTE: Spacing for Framing Members may vary due to Design Requirements

### Modular Features:

- Floorplan may be altered based on building code.
- Primed / Finished Drywall Throughout
- OSB Sheathing
- Wind Wrap
- 40# Roof Load
- 5/12 Roof Pitch w/Ice Shield
- Architectural Shingles
- 90 MPH Wind Zone Exp. C
- 2x10 Floor Joist
- 2x4 Interior Walls
- Additional Exterior Receptacle
- (1) Exterior Faucet
- Non Gridded Argon Windows Low-E
- R-31 Ceiling Insulation
- Water Shut Off Where Accessible
- 200 AMP Panel Box
- Hardwood Cabinets w/Hardwood Stiles
- No Blinds or Curtains

## CUSTOMER CONTACT

Notes:

---

---

---

---

## PRINTABLE INFO SHEET

**Series: Astro Bungalow**

**Model: 1A2601-P**



## Standards & Features (continued)

### **Modular Features: (continued)**

- White Profile Moulding Package
- Brushed Nickel Metal Faucets
- China Sinks
- Perimeter Heat
- Fiberglass One Piece Tub/Shower Combo(s)
- (1) Phone Jack

## CUSTOMER CONTACT

Notes:

---

---

---

---