

PRINTABLE INFO SHEET

Series: Astro Bungalow

Model: 1A2602-V

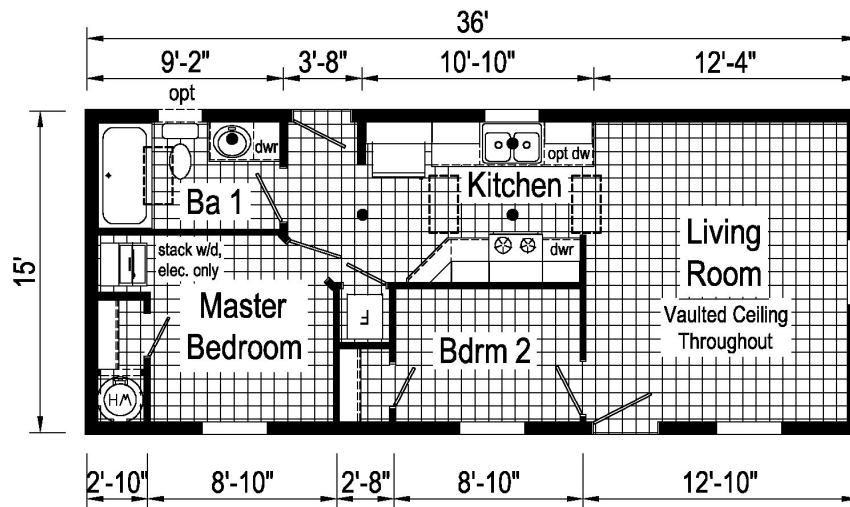

1A2602-V 1636 Approx. 540 Sq. Ft.

● = Std. can light

Astro Bungalow

Builder: Commodore Homes of Pennsylvania	Callout: 1636	Revisions: 6/25/18	Scale: 3/16" = 1'-0"	Date: 05/22/2018	Client: -	Model/Eng. No.: 1A2602-V
Title: Literature		Date: 6/29/18	Drawn By: OY	Reference: NONE	Dr: -	Pg: LIT
		Date: 8/9/18			SN: -	

About This Model

Style: Single / Bedrooms: 2 / Bathrooms: 1 / Square Feet: 540

CUSTOMER CONTACT

Notes:

PRINTABLE INFO SHEET

Series: Astro Bungalow

Model: 1A2602-V



Standards & Features

Interior

Flat Ceiling Throughout
Stipple Ceiling
8' Sidewall Height
Shaw Take Away Carpet
Rebond Carpet Pad
Tackstrip Carpet Installation
Shaw Vinyl Floor
Vinyl Wall Coverings on Gypsum
LED Flush Mount Lighting
Pre-Hung White 2-Panel Interior
Doors with 2 Mortised Hinges
30" Interior Passage Doors
Metal Interior Passage Sets
Floor Mount Door Stops
Smoke Detectors with Battery
Back-Up
Wire Shelving in Closets
Designer-Coordinated Window
Treatments

Kitchen

KCMA Certified Cabinetry
Mission Cabinet Doors
Concealed Cabinet Hinges
Brushed Nickel Cabinet Hardware
30" Staggered Overhead Cabinets
Cabinet Crown Moulding
Lined Base & Overhead Cabinets
Soft Close Undermount Drawer Guides
Base and Center Shelves in Cabinets
Laminate Countertops

Kitchen (continued)

4" Laminate Backsplash
Stainless Steel Sink - 33x22x8
Hi-Rise Empire Brushed Nickel
Kitchen Faucet

Appliances

18 Cubic Foot, Black No-Frost Refrigerator
30" Black Deluxe Gas Range
Power Range Hood with Light

Baths

60" Tub/Shower - 2 Piece
1.6 Gallon Per Flush Elongated Toilets
Laminate Countertops
4" Laminate Backsplash
Lighted Vent Fan in Each Bath
Mission Cabinet Doors
Concealed Cabinet Hinges
Brushed Nickel Cabinet Hardware
Base Shelf in Vanities
36" High Vanities
Empire Brushed Nickel Faucets

Bedrooms

Switched Receptacles
Egress Window Each Bedroom
Wire Shelving in Wardrobes
Recessed 6" LED Light
in All Walk-In Closets & Pantry

Utilities

Plumbed & Wired for Washer
with Quarter Turn Valve
Vented and Wired for Dryer

CUSTOMER CONTACT

Notes:

PRINTABLE INFO SHEET

Series: Astro Bungalow

Model: 1A2602-V



Standards & Features (continued)

Utilities (continued)

100 AMP Electrical Service
Copper Wiring Throughout
30 Gallon Electric Water Heater
with Pan
Gas Furnace w/ Grilled Door
Air Exchange System for Furnace
Aluminum Heat Ducts
In-Floor Cross-Over Heating System
Air Conditioner Thermostat w/ 5-Wires
Main Water Line Shut-Off Valve

Exterior

Gatsby Light at Front Door
Seeded Glass Jar Light at Rear Door
GFI-Protected Exterior Receptacle
Vinyl Dutch Lap Siding
Sheathing Board Under Siding
Shingle Roof with
4" Eaves on Single Section Homes
10" Eaves on Ranch Homes
Ridgevent Roof Ventilation System
6-Panel Fiberglass Front Door 38x80
6-Panel Fiberglass Rear Door 34x80
12" Raised Panel Shutters on
Front Door Side

Construction

Transverse Floor System
2x6 - 14' and 24' Wide
2x8 - 16' Wide
2x6 Exterior Walls on 16" Centers**
20# Roof Load

Construction (continued)

3/4" OSB T&G Floor Decking
Recessed Frame Design

Energy Efficient Standards

Vinyl Insulated Low-E Windows
R-22 Fiberglass in Floor
R-19 Fiberglass in Walls
R-25 Avg. Blown in Ceiling-Single
R-28 Avg. Blown in Ceiling- Multi
**NOTE: Spacing for Framing Members may vary due to
Design Requirements

Modular Features:

Primed / Finished Drywall Throughout
OSB Sheathing
Wind Wrap
40# Roof Load
5/12 Roof Pitch w/Ice Shield
Architectural Shingles
90 MPH Wind Zone Exp. C
2x10 Floor Joist
2x4 Interior Walls
Additional Exterior Receptacle
(1) Exterior Faucet
Non Gridded Argon Windows Low-E
R-31 Ceiling Insulation
Water Shut Off Where Accessible
200 AMP Panel Box
Hardwood Cabinets w/Hardwood Stiles
No Blinds or Curtains
White Profile Moulding Package
Brushed Nickel Metal Faucets

CUSTOMER CONTACT

Notes:

PRINTABLE INFO SHEET

Series: Astro Bungalow

Model: 1A2602-V



Standards & Features (continued)

Modular Features: (continued)

China Sinks

Perimeter Heat

Fiberglass One Piece Tub/Shower Combo(s)

(1) Phone Jack

CUSTOMER CONTACT

Notes:
