

PRINTABLE INFO SHEET

Series: Blazer Select

Model: TS1014-P

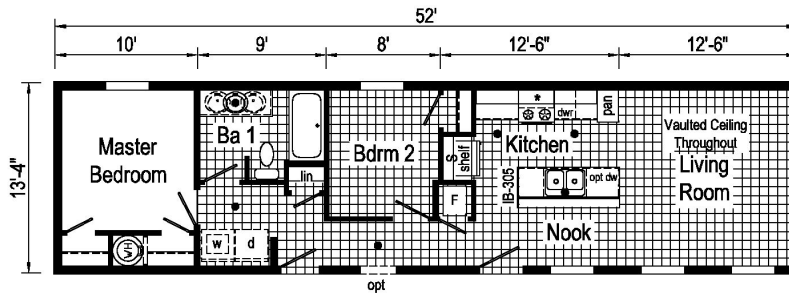

TS1014-P 1452 Approx. 693 Sq. Ft.

- = Std. can light
- S = Std. 4" staggered overhead cabinets
- * = Additional std 4" staggered overhead cabinets with opt. flat ceiling

Builder: Commodore Homes of Pennsylvania	Calcut: 1452	Revisions: 3/5/21	Scale: 1/8" = 1'-0"	Date: 01/14/2021	Cont: -	Model/Eng. No: TS1014-P
Title: Literature		Drawn By: OY	Reference: NONE		Dir: -	LIT
					SNE: ---	Pg: -

About This Model

Style: Single / Bedrooms: 2 / Bathrooms: 1 / Square Feet: 693

CUSTOMER CONTACT

Notes:

PRINTABLE INFO SHEET

Series: Blazer Select

Model: TS1014-P



Standards & Features

Interior

- Cathedral Ceiling Throughout
- Stipple Ceiling
- 7'6" Sidewall Height
- 18 oz. Carpet Lucerne/Innovations
- Rebond Carpet Pad
- Tackstrip Carpet Installation
- No-Wax Diamond Floor Vinyl Flooring
- Vinyl Wall Coverings on Gypsum
- Pre-Hung White 6-Panel Interior
- Doors with 2 Mortised Hinges
- 30" Interior Passage Doors
- Metal Interior Passage Sets
- Floor Mount Door Stops
- Smoke Detectors with Battery Back-Up
- Wire Shelving in Closets
- Designer-Coordinated Window Treatments
- LED Lights Throughout (except Bedrooms)

Kitchen

- KCMA Certified Cabinets
- Mission Cabinet Doors
- Concealed Cabinet Hinges
- Brushed Nickel Cabinet Hardware
- 30" Staggered Overhead Cabinets
- Lined Base & Overhead Cabinets
- Soft Close Undermount Drawer Guides
- Base Shelves in Cabinets
- Laminate Countertops
- 4" Laminate Backsplash

Kitchen (continued)

- Stainless Steel Sink - 33x19x7
- Hi-Rise Empire Brushed Nickel Kitchen Faucet

Appliances

- 18 Cubic Foot, Black No-Frost Refrigerator
- 30" Black Deluxe Electric Range
- Power Range Hood with Light

Baths

- 60" Tub/Shower - 2 Piece
- 1.6 Gallon Per Flush Elongated Toilets
- Laminate Countertops
- 4" Laminate Backsplash
- Lighted Vent Fan in Each Bath
- Mission Cabinet Doors
- Concealed Cabinet Hinges
- Brushed Nickel Cabinet Hardware
- Base Shelf in Vanities
- 36" High Vanities
- Empire Brushed Nickel Faucets

Bedrooms

- Switched Receptacles
- Egress Window Each Bedroom
- Wire Shelving in Wardrobes
- Recessed 4" LED Light in All Walk-In Closets & Pantry

Utilities

- Plumbed & Wired for Washer with Quarter Turn Valve
- Vented and Wired for Dryer
- 200 AMP Electrical Service

CUSTOMER CONTACT

Notes:

PRINTABLE INFO SHEET

Series: Blazer Select

Model: TS1014-P



Standards & Features (continued)

Utilities (continued)

Copper Wiring Throughout
30 Gallon Electric Water Heater
with Pan
Electric Furnace w/ Grilled Door
Air Exchange System for Furnace
Aluminum Heat Ducts
In-Floor Cross-Over Heating System
Air Conditioner Ready Thermostat
w/ 5-Wires
Main Water Line Shut-Off Valve

Exterior

Black Coach Light at Front Door
Seeded Glass Light at Rear Door
GFI-Protected Exterior Receptacle
Vinyl Dutch Lap Siding
Sheathing Board Under Siding
Shingle Roof with
" Eaves on Single Section Homes
10" Eaves on Ranch Homes
Ridgevent Roof Ventilation System
6-Panel Fiberglass Front Door 38x80
6-Panel Rear Door 34x80
12" Raised Panel Shutters on
Front Door Side

Construction

Transverse Floor System
2x6 - 14' & 28' Wide
2x8 - 16' & 32' Wide

2x6 Exterior Walls on 16" Centers**

20# Roof Load

2x6 Exterior Walls on 16" Centers** (continued)

$\frac{3}{4}$ " OSB T&G Floor Decking
Recessed Frame

Energy Efficient Standards

Vinyl Insulated Low-E Windows
R-14 Fiberglass in Floor
R-19 Fiberglass in Walls
R-25 Avg. Blown in Ceiling-Single
R-28 Avg. Blown in Ceiling-Multi

****NOTE: Spacing for Framing Members may vary due to Design**

CUSTOMER CONTACT

Notes:
