

# PRINTABLE INFO SHEET

Series: Blazer Select

Model: TS1019-P

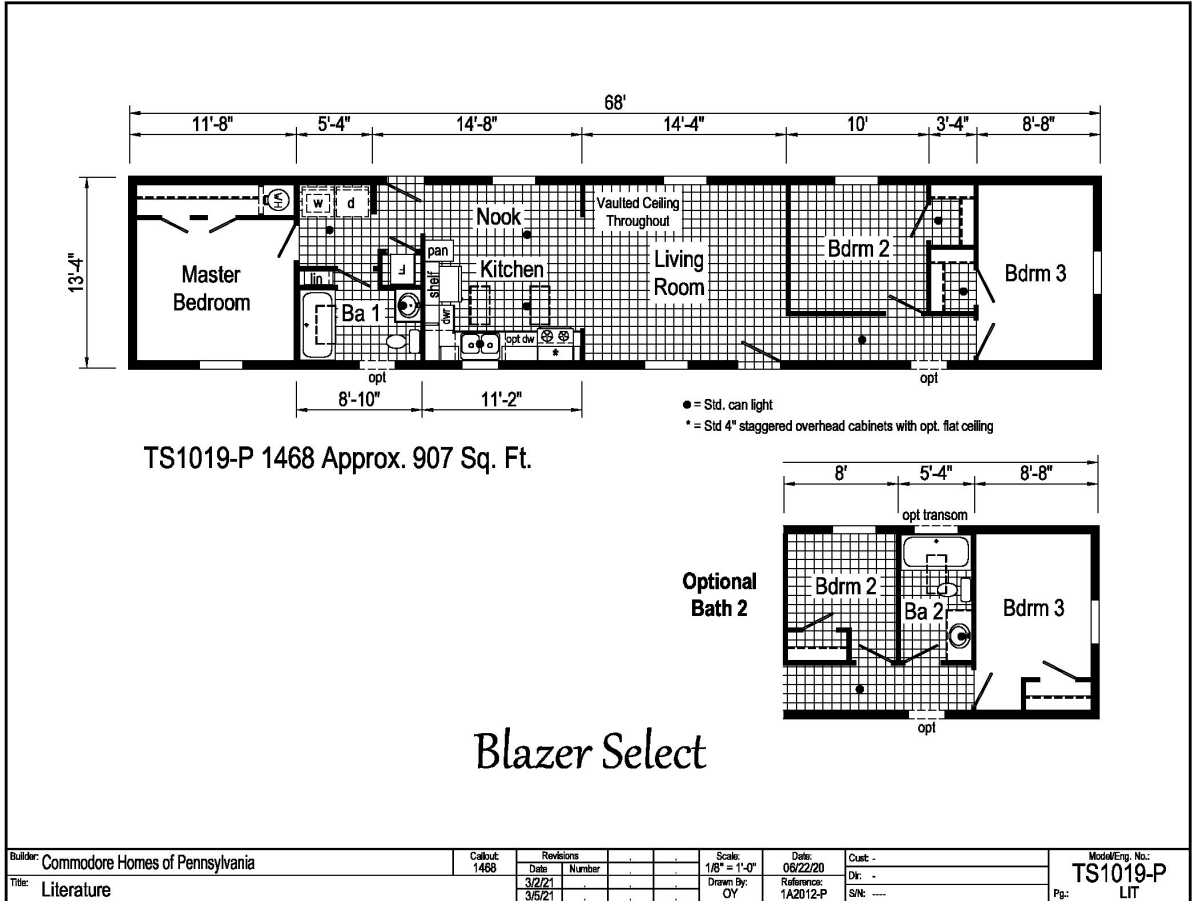

## About This Model

Style: Single / Bedrooms: 3 / Bathrooms: 1 / Square Feet: 907

## CUSTOMER CONTACT

Notes:

---



---



---



---

# PRINTABLE INFO SHEET

**Series: Blazer Select**

**Model: TS1019-P**



## Standards & Features

### Interior

- Cathedral Ceiling Throughout
- Stipple Ceiling
- 7'6" Sidewall Height
- 18 oz. Carpet Lucerne/Innovations
- Rebond Carpet Pad
- Tackstrip Carpet Installation
- No-Wax Diamond Floor Vinyl Flooring
- Vinyl Wall Coverings on Gypsum
- Pre-Hung White 6-Panel Interior
- Doors with 2 Mortised Hinges
- 30" Interior Passage Doors
- Metal Interior Passage Sets
- Floor Mount Door Stops
- Smoke Detectors with Battery Back-Up
- Wire Shelving in Closets
- Designer-Coordinated Window Treatments
- LED Lights Throughout (except Bedrooms)

### Kitchen

- KCMA Certified Cabinets
- Mission Cabinet Doors
- Concealed Cabinet Hinges
- Brushed Nickel Cabinet Hardware
- 30" Staggered Overhead Cabinets
- Lined Base & Overhead Cabinets
- Soft Close Undermount Drawer Guides
- Base Shelves in Cabinets
- Laminate Countertops
- 4" Laminate Backsplash

### Kitchen (continued)

- Stainless Steel Sink - 33x19x7
- Hi-Rise Empire Brushed Nickel Kitchen Faucet

### Appliances

- 18 Cubic Foot, Black No-Frost Refrigerator
- 30" Black Deluxe Electric Range
- Power Range Hood with Light

### Baths

- 60" Tub/Shower - 2 Piece
- 1.6 Gallon Per Flush Elongated Toilets
- Laminate Countertops
- 4" Laminate Backsplash
- Lighted Vent Fan in Each Bath
- Mission Cabinet Doors
- Concealed Cabinet Hinges
- Brushed Nickel Cabinet Hardware
- Base Shelf in Vanities
- 36" High Vanities
- Empire Brushed Nickel Faucets

### Bedrooms

- Switched Receptacles
- Egress Window Each Bedroom
- Wire Shelving in Wardrobes
- Recessed 4" LED Light in All Walk-In Closets & Pantry

### Utilities

- Plumbed & Wired for Washer with Quarter Turn Valve
- Vented and Wired for Dryer
- 200 AMP Electrical Service

## CUSTOMER CONTACT

Notes:

---

---

---

---

## PRINTABLE INFO SHEET

Series: Blazer Select

Model: TS1019-P



## Standards & Features (continued)

### Utilities (continued)

Copper Wiring Throughout  
30 Gallon Electric Water Heater  
with Pan  
Electric Furnace w/ Grilled Door  
Air Exchange System for Furnace  
Aluminum Heat Ducts  
In-Floor Cross-Over Heating System  
Air Conditioner Ready Thermostat  
w/ 5-Wires  
Main Water Line Shut-Off Valve

### Exterior

Black Coach Light at Front Door  
Seeded Glass Light at Rear Door  
GFI-Protected Exterior Receptacle  
Vinyl Dutch Lap Siding  
Sheathing Board Under Siding  
Shingle Roof with  
" Eaves on Single Section Homes  
10" Eaves on Ranch Homes  
Ridgevent Roof Ventilation System  
6-Panel Fiberglass Front Door 38x80  
6-Panel Rear Door 34x80  
12" Raised Panel Shutters on  
Front Door Side

### Construction

Transverse Floor System  
2x6 - 14' & 28' Wide  
2x8 - 16' & 32' Wide

### 2x6 Exterior Walls on 16" Centers\*\*

20# Roof Load

### 2x6 Exterior Walls on 16" Centers\*\* (continued)

3/4" OSB T&G Floor Decking  
Recessed Frame

### Energy Efficient Standards

Vinyl Insulated Low-E Windows  
R-14 Fiberglass in Floor  
R-19 Fiberglass in Walls  
R-25 Avg. Blown in Ceiling-Single  
R-28 Avg. Blown in Ceiling-Multi

**\*\*NOTE: Spacing for Framing Members may vary due to Design**

## CUSTOMER CONTACT

Notes:

---

---

---

---