

## PRINTABLE INFO SHEET

**Series: Pinecrest Elite Modular**

**Model: PGM5009-P**



## About This Model

**Style: Ranch / Bedrooms: 3 / Bathrooms: 2 / Square Feet: 1493**

## CUSTOMER CONTACT

Notes:

---

---

---

---

## PRINTABLE INFO SHEET

Series: Pinecrest Elite Modular

Model: PGM5009-P



## Floorplan

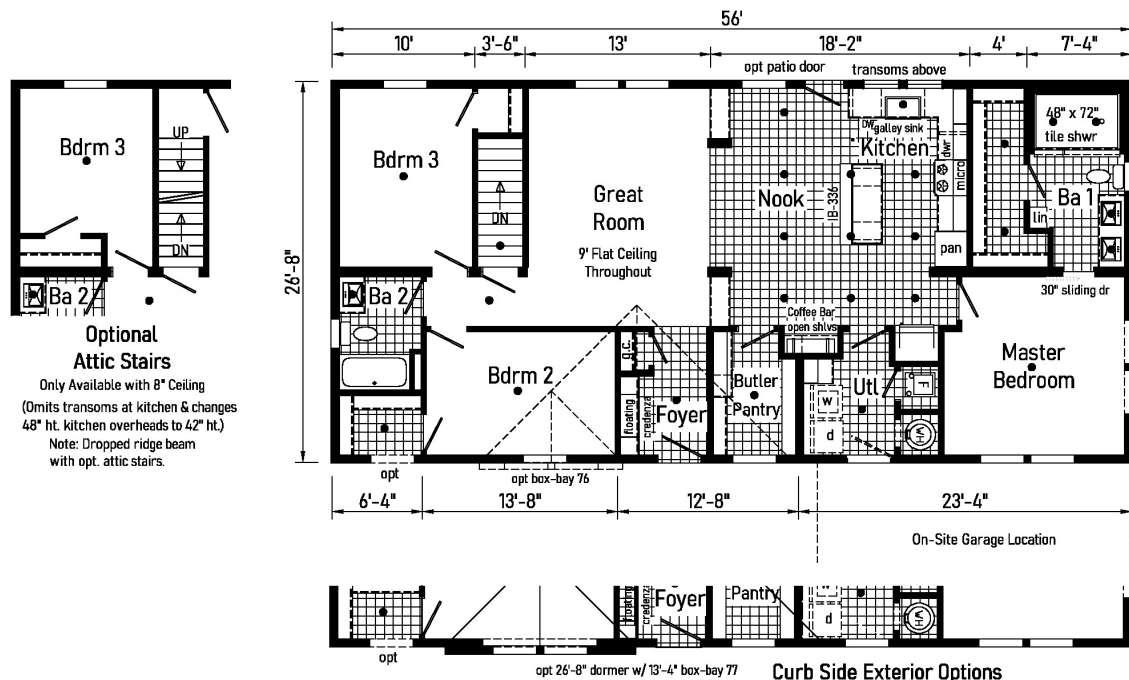

## CUSTOMER CONTACT

Notes:

---

---

---

---

## PRINTABLE INFO SHEET

**Series: Pinecrest Elite Modular**  
**Model: PGM5009-P**



## Standards & Features

### Interior

Flat Coveless Ceiling Throughout  
Smooth Ceiling  
9' Sidewall Height  
25 oz. Shaw Shake it Up Carpet  
Rebond Carpet Pad  
Tackstrip Carpet Installation  
Shaw Vinyl Floor  
Finished Drywall  
LED Flush Mount Lighting  
Pre-Hung White 2-Panel Interior  
Doors with 2 Mortised Hinges  
Sliding Barn Doors (per print)  
Metal Interior Passage Sets  
Floor Mount Door Stops  
Smoke Detectors with Battery  
Back-Up  
Wire Shelving in Closets  
Utility Sink  
White Moulding Package

### Kitchen

KCMA Certified Cabinetry  
Hardwood Mission Cabinet Doors  
with Hardwood Stiles  
Concealed Cabinet Hinges  
48" Door over Door Overhead Cabinets  
with Cabinet Crown Moulding  
Hardwood Under Cabinet Moulding  
Lined Base & Overhead Cabinets  
Soft Close Undermount Drawer Guides  
Base and Center Shelves in Cabinets

### Kitchen (continued)

Laminate Countertops w/ Crescent Edge  
Apron Galley Sink w/ Brushed Nickel Metal Spring  
Pull Out Faucet  
Full Ceramic Backsplash on Range Wall  
Single Row Ceramic Backsplash on  
Window Wall  
Refrigerator Surround

### Appliances

Pearl Appliance Package:  
25 CuFt French Door By Side Stainless Steel Refrigerator  
with Water and Ice Maker  
Self Clean Stainless Steel Free Standing Range  
Tall Tub Stainless Steel Dishwasher  
Stainless Steel Microwave above Range

### Baths

48"x72" Ceramic Shower in Master Bath  
1.6 Gallon Per Flush Elongated Toilets  
Framed Mirrors at Master Bath  
Square China Lav Sinks  
Laminate Countertops with  
Laminate Backsplash and Crescent Edge  
Lighted Vent Fan in Each Bath  
Hardwood Mission Cabinet Doors  
Concealed Cabinet Hinges  
Base Shelf in Vanities  
36" High Vanities  
Structured Flow Brushed Nickel Faucets

### Bedrooms

Ceiling Lights (LED)  
Egress Window Each Bedroom

## CUSTOMER CONTACT

Notes:

---

---

---

---

## PRINTABLE INFO SHEET

**Series: Pinecrest Elite Modular**  
**Model: PGM5009-P**



## Standards & Features (continued)

### Bedrooms (continued)

Wire Shelving in Wardrobes  
Recessed 6" LED Light  
in All Walk-In Closets & Pantry

### Utilities

Plumbed & Wired for Washer  
with Quarter Turn Valve  
Vented and Wired for Dryer  
200 AMP Electrical Service  
Copper Wiring Throughout  
30 Gallon Electric Water Heater with Pan  
Hi-Efficiency Gas Furnace w/ Grilled Door  
Air Exchange System for Furnace  
Insulated Heat Ducts  
Perimeter Heat  
Air Conditioner Thermostat w/ 5-Wires  
Main Water Line Shut-Off Valve  
Water Shut Offs - Where Accessible

### Exterior

Gatsby Light at Front & Rear Door  
(2) GFI-Protected Exterior Receptacle  
Vinyl Dutch Lap Siding  
OSB Sheathing  
Wind Wrap  
5/12 Architectural Shingle Roof with  
10" Eaves on Ranch Homes  
Ice Shield  
Ridgevent Roof Ventilation System  
6-Panel Fiberglass Front Door 38x80  
6-Panel Fiberglass Rear Door 34x80  
12" Raised Panel Shutters on

### Exterior (continued)

Front Door Side  
Exterior Faucet  
68" Non Gridded Argon Windows Low-E

### Construction

2x10 Floor Joists  
2x6 Exterior Walls on 16" Centers\*\*  
2x4 Interior Walls  
40# Roof Load  
3/4" OSB T and G Floor Decking

### Energy Efficient Standards

Vinyl Insulated Low-E Windows Argon  
R-19 Fiberglass in Walls  
R-31 Avg. Blown in Ceiling- Multi  
10 Year Warranty

**\*\*NOTE: Spacing for Framing Members may vary due to Design**

## CUSTOMER CONTACT

Notes:

---

---

---

---